

2MP face capture box camera

Model : FS-FW6236IQ97B



Features:

- ◆1/2" Sony 2MP CMOS sensor
- ◆Deep learning face algorithm is adopted to extract face feature value comparison and output the optimal picture
- ◆Detect,track,score and screen the moving face,and output the optimal face capture graph
- ◆Support face capture automatic image matting output function,
- ◆Support face entry and exit mode to automatically screen the optimal face and reduce repeated capture pat
- ◆ Support background full image image character,time,device name superposition function
- ◆Max. resolution 2M(1920X1080 @ 30fps)
- ◆Support low bit rate,low delay and ROI enhance encoding
- ◆Support multi-line OSD,OSD color can be adjusted
- ◆Support corridor mode,increase the monitoring area in longitudinal strip environment
- ◆Support 3D digital N/R,WDR
- ◆Support auto electronic shutter function,adapt different monitoring environment
- ◆Support various intelligent alarm
- ◆Support GB28181,Onvif access
- ◆Support HTTPS encryption transmission
- ◆Original equipment boot to modify password,ensure password security
- ◆Support Email,FTP,NTP,DDNS
- ◆Support 1CH alarm input / 1CH alarm output
- ◆Support Micro SD card (128G) local-storage
- ◆Support PoE (optional)

Specification

Camera

Image sensor	1/2" Sony 2MP CMOS sensor
Min.illumination	Color: 0.002Lux/F1.4,B/W:0.0005Lux/F1.4
Electronic shutter	Auto/ Manual(1/5~1/100000),FLK
Day/ Night	ICR switch,auto,color,B/W
Lens interface	CS(DC driver)
S/N ratio	≥50db (AGC OFF)
WDR	WDR(Off/Low/Middle/High)
Light board control	Auto/ Manual/Off
3D N/R	Off/ Low/ Middle/ High/ Higher
Defog	Off/ Low/ Middle/ High
Mirror	Off/ Horizontal/ Vertical/ 180° rotation/ Corridor mode(90° rotation,270° rotation)
Slow Shutter	Off/On,default off
Exposure control	Shutter/ Gain
Image setting	Brightness,Contrast,Saturation,Sharpness,Hue,Whitite Balance
AUDIO/VIDEO ENCODING	
Video compression	H.264
Encoding	Main Profile
H.264 Encoding	BaseLine / Main Profile / High Profile
Encoding features	NTSC: main stream: 1920X1080@30fps,sub-stream: D1@30fps PAL: main stream: 1920X1080@25fps,sub-stream: D1@25fps
Third stream	NTSC/PAL : 1920X1080@10fps
Video bit rate	Constant bit rate,variable bit rate (16kbps~8000kbps)
Video type	Complex stream/ Video stream
Audio compression	G.711u
Audio bit rate	64Kbps
Audio control	Input volume (0-100) , output volume (0-100)
ROI	Support 4 zones,multi-stage level
NETWORK	
Network protocol	TCP/IP,UDP,HTTP,DHCP,RTSP,DDNS,NTP,PPPoE,UPnP,SMTP,FTP
Access protocol	ONVIF,GB28181 (optional)
Browser	Support IE11
Video preview meanwhile	8
User permission	User add/ modify/ delete,permission management
Safe mode	Authorized user name and password,HTTPS encryption and AES link encryption,RTSP verification
Motion detection	Set detection zone,Multi-level sensitivity can be set
Tampering alarm	1 zone
Privacy Mask	4 zones
Intelligent analysis	Target Counting, Left/Loss, Area Detection, Line Crossing,Face Capture
Event linkage	Snapshot,TF card video,FTP upload or Email sending,alarm output linkage,preset

	linkage
Multicast function	Support
ANR	Support,match with NVR
Mobile surveillance	Support Apple,Android
Device exception detection	Support network disconnected,IP conflict,illegal access alarm
OSD	Title,time and date overlay,multi-line OSD,OSD color optional
DST	Support
Snapshot	Support snapshot,snapshot resolution is encoding resolution
System update	Support remote update
FACE CAPTURE	
Face detection number	Sync detection≤30pcs static faces targets, ≤10pcs dynamic faces targets
Face detection size	Face pixel : ≥80x80 (Capture pixel of face detection:32~300)
Posture	Capture within 20 degrees in vertical and 30 degrees in horizontal
Shelter	Recognizable with ordinary glasses and short bangs hair
Expression	Recognizable with slight expression
Capture rate	Capture rate≥99% (meet the above conditions)
Response rate	≤1 second
Face repetition remove	Interval capture (Interval time:1~10000ms)
	Entry capture (Entry time:1~10000ms) , capture number (1~3)
	Leave capture (Capture number1~3)
	Entry and leave capture
Face quality filtering	FaceQualityThreshold(0~10),the higher the value the better the quality of captured images
	Capture picture quality (1~99)
	Max. image size(32~1920pixels)
Face detection area	Face detection area size adjustment
	Face shielding area size adjustment
Largest face only	Only detect the largest face in the front of the capture/close
Max. detection frame rate	15fps
Face ID quality score	On/off
Scene Graph	On/off
Face tracking	Face detection and tracking/off
Face dynamic exposure	Support
Image format	Output face features image, full image, jpg. format image
Upload mode	FTP、SDK/API、GA/T1399 1400
	Face data information (time, ID, score, etc.)
INTERFACE	
Network interface	RJ45 10M/100M network adaptive
Audio	1CH (Line in) \1CH (Line out)

Alarm input	1CH input
Alarm output	1CH output
Reset	Support
RS485	Support
TF card	Support Max 128G, Micro SD(SDHC /SDXC) card local-storage
GENERAL	
Operating temperature	-20°C ~ 55°C
Operating humidity	0 % -90 %
Protection grade	/
Power supply	DC12V/AC24V optional
PoE	Optional
Power consumption (max)	<6W
Dimensions(mm)	62(W)*58(H)*138(L)mm
Weight/PCS(g)	400g

Dimension and Interface

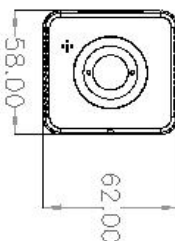
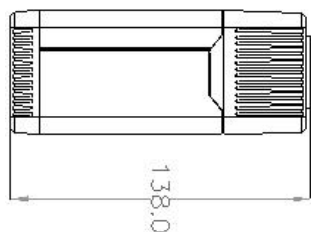

- 1-alarm out 2-alarm in
- 3-RS485 4-NC
- 5-power input 6-network
- 7-reset 8-audio in
- 9-audio out 10-TF slot